



This is a family of products based on the most advance CMOS mixed signal technology. It integrates image array, signal processing, timing and control circuitry, all on a single chip. It is ideal for applications requiring a small footprint, low power and low cost.

Features:

- Small size : 16 x 32 mm
- Resolution: 100Kpixels
- Wide operation voltage (8 - 15V)
- Built in lens with IR cut filter
- Low power consumption (<300mW typ.)
- Direct connect to standard video monitor
- On-chip auto exposure control

- Gamma correction - 0.45/1.0
- Auto gain control - 27dB
- Automatic white balance



Application Example

- Video conferencing
- Video Phone
- PC multimedia
- Security and Surveillance System
- Toys

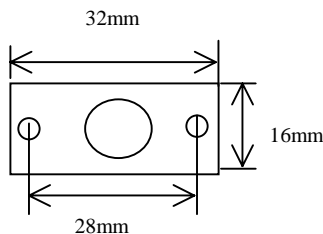

Specification

	C6915S(PAL)	C6916S (NTSC)
Imager	CMOS imager sensor OV6910	
Scanning	2:1 Interlace	
Shutter	1/60 to 1/15,000 sec	
Video Output	Composite video (75Ω)	
Picture Element	366x288 pixel	306x240 pixel
Effective image area	2.85x2.16mm	2.39x1.8mm
S/N Ratio	>48dB (AGC on)	
Fixed pattern noise	<0.03% Vp-p	
Dark Current	<0.2nA/cm ²	
Dynamic range	>72dB	
Min Illumination	<2 Lux at f1.2 (3000K)	
Operation Voltage	8 - 15 VDC	
Connectors	PWR, Video, GND	
Lens	f4.9 F2.8 with IR cut	

Pin Description

1. CVO Composite Video Output
Direct connect to TV/Monitor
2. GND Common Ground for power and video
3. PWR Power Supply 8-15V DC

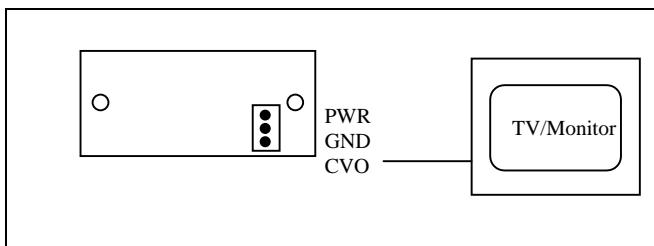

Electrical Characteristic at 25C

	Min	Typ	Max	Unit
Operation Voltage	8	9	15	V
Operation Current	28	29	31	mA
Operation Temperature	0		45	deg C

Note: operation current may be varied by the brightness of image.